

PURPLE LINE

Art-in-Transit

Takoma Langley

Volkan Alkanoglu

CONCEPT

Our art proposal for the Takoma Langley Station is named 'In Motion'. It consists of two art fences which partly replace the proposed fence and occupy both sides of the station along the walkways (67 feet on the left and 190 feet on the right) leading to the platform.

Our art piece is inspired by the ever changing, diverse and colourful community of the neighbourhood. We want to celebrate the multi-ethnic heritages and bring people together onto one 'canvas'. We will integrate individuals and families originally from areas such as West Africa, Central America, Southeast Asia, the Caribbean and many others places to name a few.

We also want to showcase the constant flux of traveling and commuting and constant change within the neighbourhood and community.

Everything around us is in constant motion. We want to capture a 'moment in time' through photography and its translation to a large scale collage of this community. We want to create a timeless art piece which represents the past, present and future all at once.

It is important for us to integrate the local community into the art work by literally taking pictures of community members and creating an abstract art piece which is lively, timeless and inspiring.

We have reached out to the Langley Park Community Center and will work closely with them to create photography that will be translated into the art piece as a large scale collage of images and pictures. This collage will be computed into a circle pattern and projected onto sheets of metal, cutting out thousands of circular openings into the material. Each circle will have a different size, dimensions and the array of these openings represent the large and diverse community at Takoma and Langley Park.

We will start the project with making a visit to the site and meeting members of the Takoma Langley Park community.

As part of our proposal we will include photography of community members, families having a picnic or BBQ and children into our art work. We have discussed this strategy with Alvin Whitley who is the director at the Langley Park Community Center and with Kira Calm-Lewis who is the Media Relations manager for the Prince George's County Department of Parks and Recreation.

In close collaboration with the Langley Park Community Center, which is in the immediate neighbourhood of the site, we will organize and host a summer event where we will capture the life, spirit and diversity of the Langley community and take pictures. We will talk about art and discuss with the community how it can brighten up our daily life by showing examples of art around the world.

The process for respected consensus for any photography will be organized by the center and PG Parks accordingly to benefit the Langley Park Community Center.

Conceived as a linear aluminium structure, the art piece will be both functional and inspirational while acting as a colourful sculptural addition to the station. The long mural will immediately face the Takoma Langley Crossroads Transit Center and become a colourful and inspirational canvas for the passenger and commuters of the station.

Our concept is to create visual ambiguity and play with effects that are created with the blending, overlay, shadows and other visual parameters. We are interested for the artwork to constantly appear in new light, change and transform during the day offering constantly new views, thoughts, and inspiration to its viewers. With a series of individual and unique engraved images, the art piece appears to be in motion and constantly changing.

The art piece will be digitally fabricated out of aluminium sheets and painted for long term sustainability. The aluminium panels will be held in place by a substructure which will be anchored to the walkway. The individual composition of panels of the art piece is giving the opportunity for every component to be custom and individual, yet being integrated into a larger assemblage.

We acknowledge for the need to collaborate with the architect, general engineering consultant (PLTC) and general contractor on finalizing installation details.

Our art proposal represents the forward looking and dynamic community of the Takoma Langley Park area.

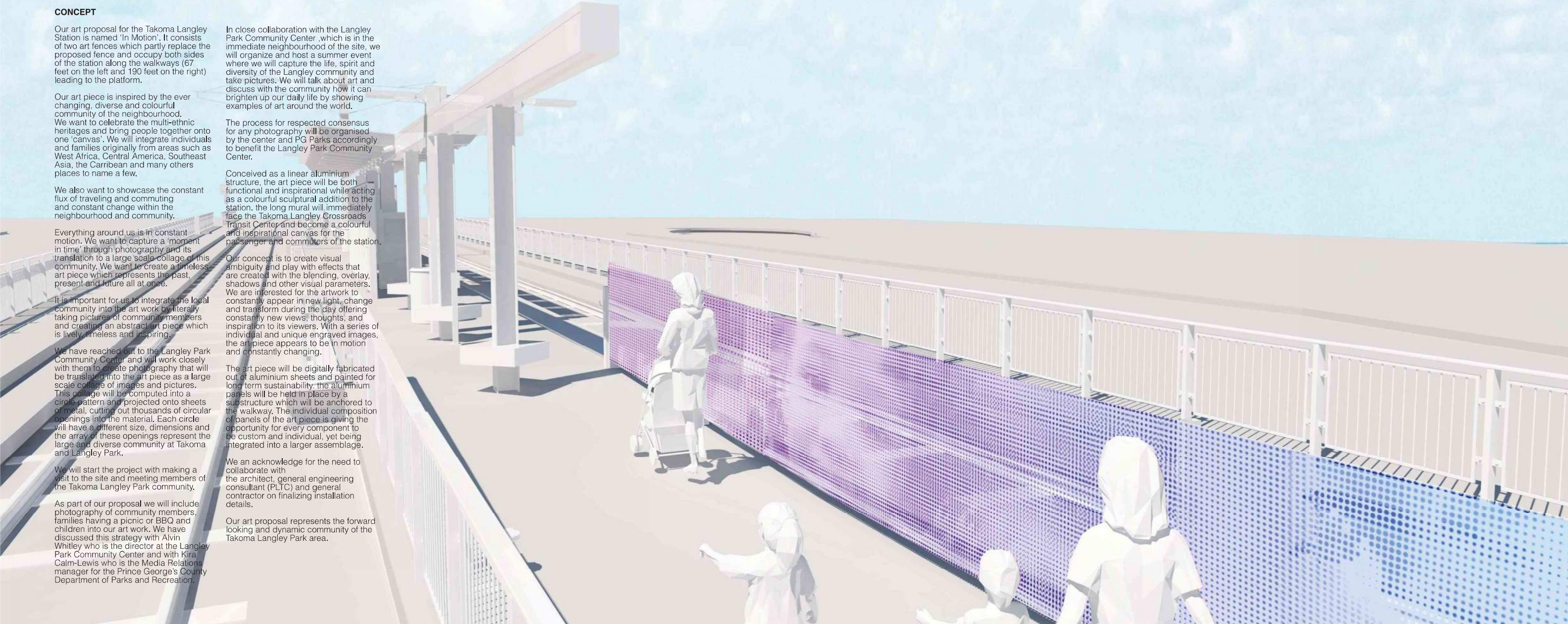

PERSPECTIVE VIEW

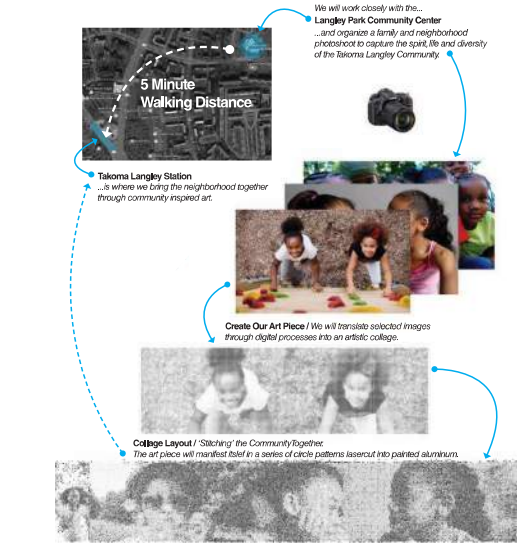

PROCESS INVOLVING COMMUNITY

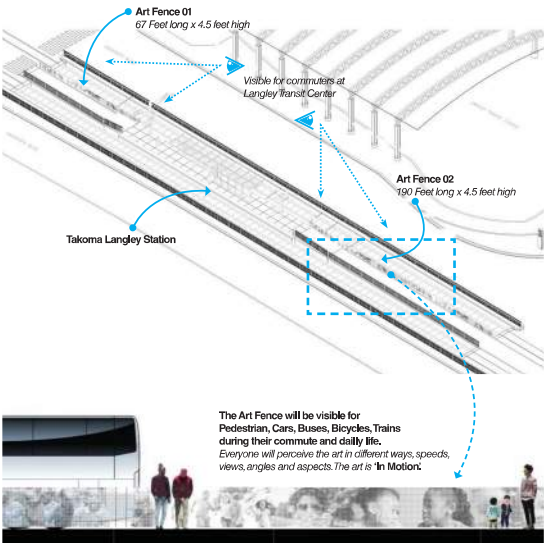

LOCATION AND DIMENSIONS

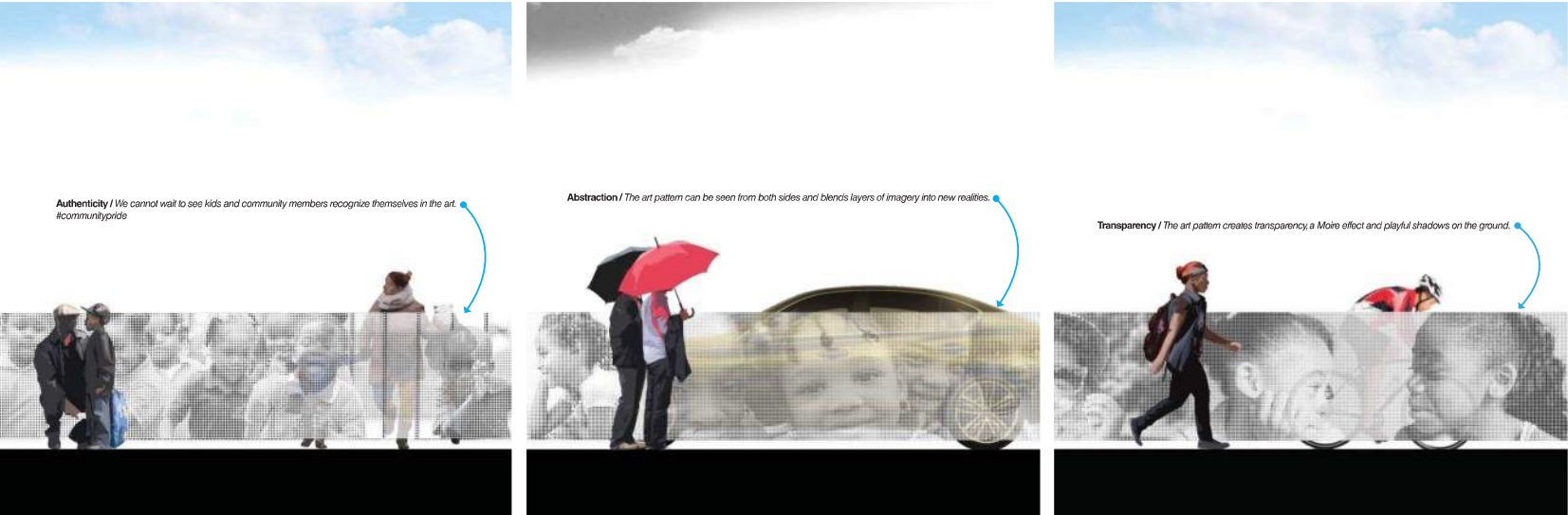

DETAIL VIEWS

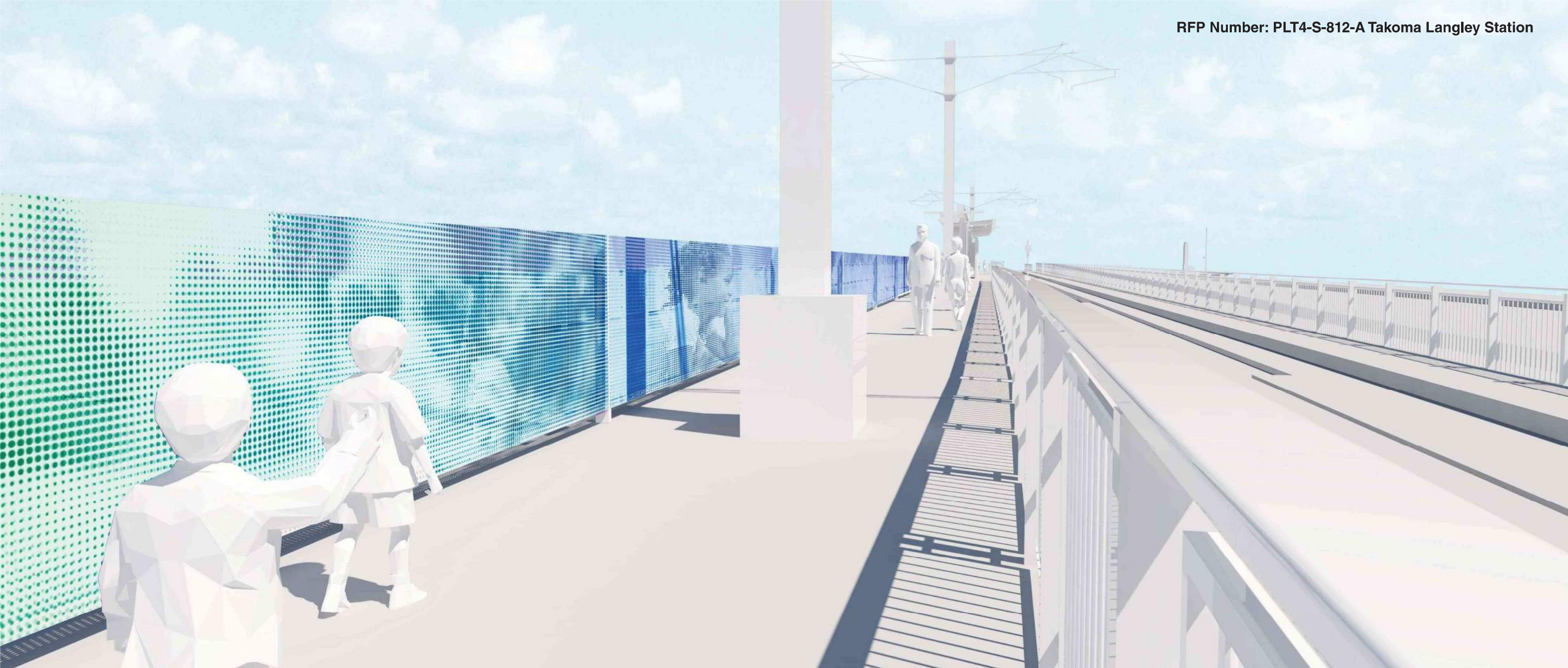

PERSPECTIVE VIEW



COLOR STUDIES

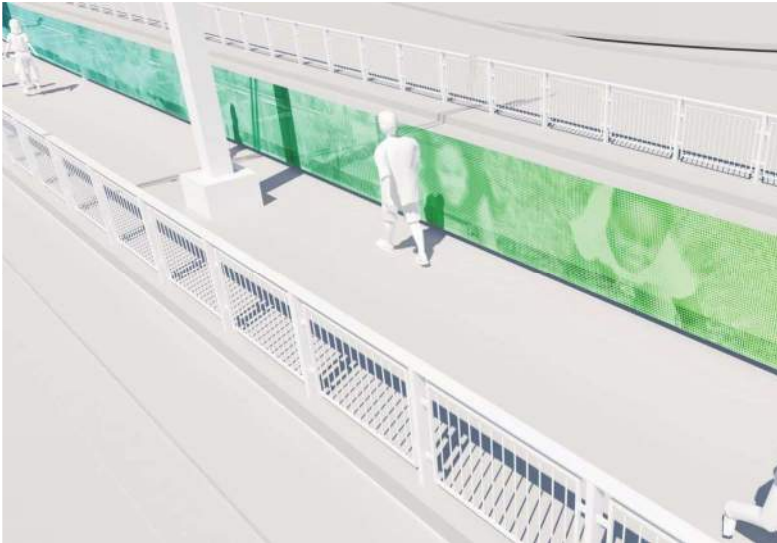

PERSPECTIVE VIEW



ELEVATION VIEW